

## KEY TO GENERAL ARRANGEMENT DETAILS

Keys not to scale  
Some symbols shown might not appear on the drawing

- Existing structural basebuild wall
- Existing partition
- New 75mm solid stud partition (Single skin)
- New 100mm solid stud partition (Single skin)
- New 100mm solid stud partition (Double skin)
- New 196mm partition (Double skin)
- New partition (Detail t.b.c.)

**Note:- All partitions to be 'raised floor to underside of suspended ceiling' - Unless otherwise noted (See below)**

- Raised floor to ceiling slab
- Floor slab to underside of suspended ceiling
- Floor slab to ceiling slab
- Sound barrier partition
- Fire barrier partition
- Plywood partition strengthening
- Mdf partition strengthening

- ### GLAZING DETAILS
- Existing silicon glass
  - Existing glazed module
  - New single glazed silicon glass
  - New double glazed silicon glass
  - New single glazed module
  - New double glazed module

- ### DOOR DETAILS
- Existing door
  - Relocated door
  - New solid framed door
  - New glass framed door
  - Standard height doors unless otherwise stated
  - Full height doors unless otherwise stated
- EX1=Existing 1st floor door, EX2=Relocated 1st floor door, N1=New 1st floor door, N2=Relocated 1st floor door
- V.P. = Vision panel, 01 = Door No., SEC = Security door  
FD20S = Fire door rated with smoke seal, FD20S =20 min, FD30S =30 min, FD60S =60 min
- R1-01 = 1st floor room, R1 = Room no., W1-01 = 1st floor window, W1 = Window no.

- Comms floor
- Vinyl floor
- Wood floor
- Tiled floor
- Existing furniture
- New furniture
- Expansion furniture
- Low height (Tambour unit)
- Medium height (Drawer unit)
- High height (Door unit)
- General Storage wall
- Clear Storage wall
- Roller Storage
- Credenza
- Racking System
- Filing Cabinet
- Benching / Worksurface
- DDA compliant benching / worksurface
- General shelving

## DRAWING STATUS

**AS BUILT**

PRE CONSTRUCTION / APPROVAL / CONSTRUCTION AS BUILT

Notes: This drawing must be signed otherwise it will be invalid  
Building parameters taken from as built drawings provided  
Check survey undertaken only, subject to statutory approval  
All dimensions shown are in millimetres unless otherwise shown

## QUALITY CONTROL

**MARIS**  
DESIGNED BY: ARCHITECTURAL TECHNOLOGY  
DESIGN DIRECTOR: \_\_\_\_\_  
TECHNICAL DIRECTOR: \_\_\_\_\_  
SUPERVISOR: \_\_\_\_\_  
DATE: \_\_\_\_\_

**CLIENT**  
SIGNED: \_\_\_\_\_  
PRINT NAME: \_\_\_\_\_  
SIGNATURE OF: \_\_\_\_\_  
DATE: \_\_\_\_\_

## REVISION SCHEDULE

No.	Descriptive amendments	By	Date

## Willful Holdings

4th Floor - General Arrangement

21282 01 4th GA AB  
Project No Building Floor Detail Rev

Project Address: 2 Great Titchfield St  
London W1D 1NN

Drawing Produced by: AJH  
Amended Date: 06/05/2016  
Scale: 1:100@A1

**MARIS INTERIORS LLP**  
The Harlequin Building T 020 7902 1750  
65 Southwark Street E maris@maris-interiors.co.uk  
London SE1 0HR W maris-interiors.co.uk

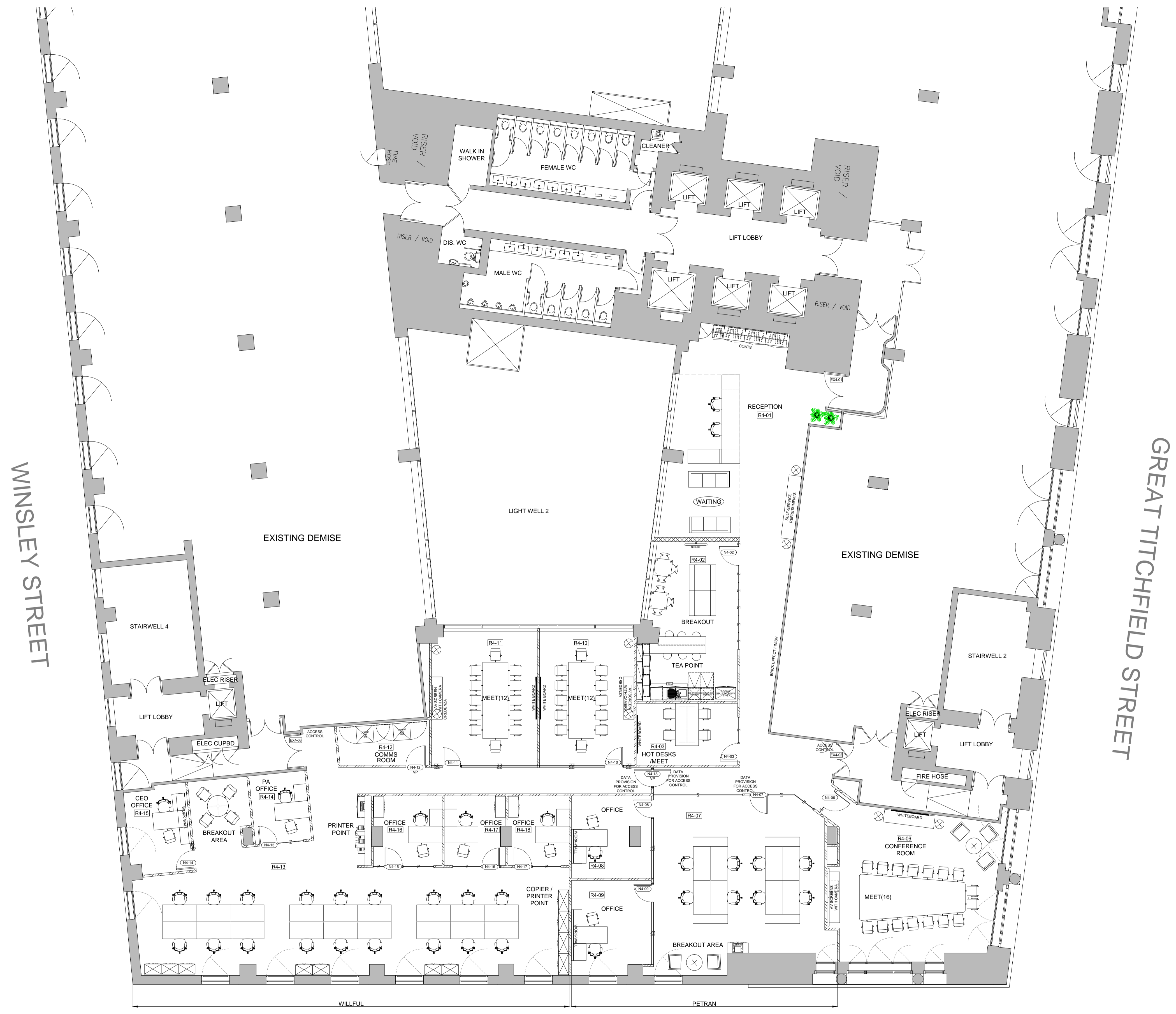

## EASTCASTLE STREET

WINSLEY STREET

GREAT TITCHFIELD STREET